

CATALOG NUMBER	TYPE

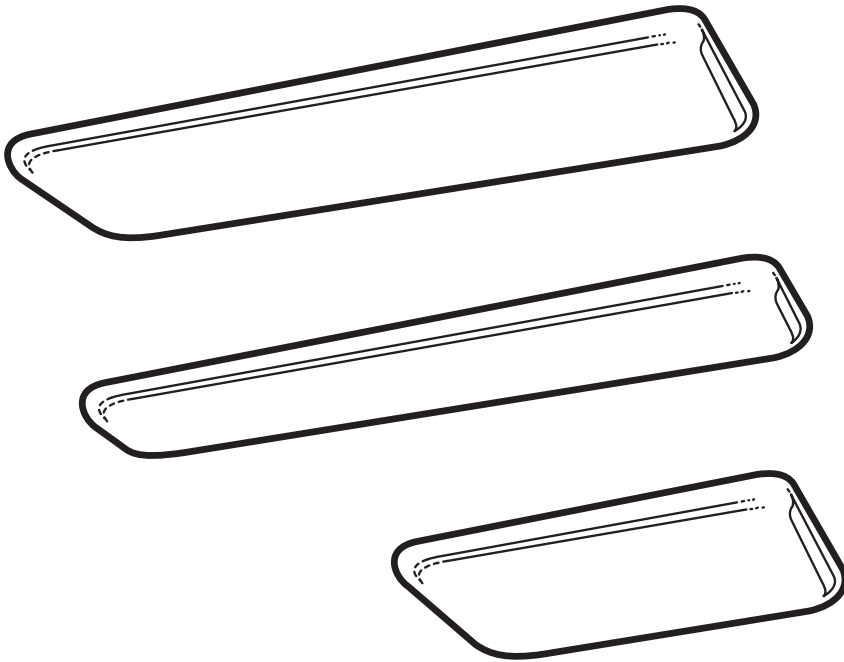

**Housing:** Die-formed heavy gauge steel with high-gloss baked white enamel finish (minimum reflectance 86%) over rust inhibiting phosphate coat.

**Shielding:** Translucent white acrylic diffuser.

**Electrical:** Fluorescent wired for 120V, 60Hz AC operation, thermally protected, Class P, sound rated A, energy saving ballast, unless otherwise specified. Magnetic T12 shall be high power factor. Electronic T8 shall be high power factor, instant start, <20% harmonic distortion standard, specify suffix UNV for <10% harmonic distortion. Specify suffix UNV for universal voltage, 120 through 277V, 50/60Hz AC operation, Electronic T8 only. UL and C-UL listed.

**Mounting:** Ceiling mount.

**Critical Application:** SIMKAR strives to offer the most current product designs and value. Consequently, all SIMKAR products are subject to redesign and revision. Critical applications such as size, operating temperature, or sensor operation should be confirmed with the factory.

**FEATURES AND BENEFITS**

- Translucent white acrylic diffuser ➤ Soft, even illumination; flawless look
- Lift & Shift diffuser ➤ Easy cleaning and relamping without tools
- Wall & Sconce companion fixtures ➤ Coordinated décor

**ORDERING INFORMATION**

Example: SMC232B11120V

**SMC**

**SERIES**  
SMC - Ceiling

**LAMPS**  
232 - (2) 32W 48" T8  
240 - (2) 34/40W 48" T12  
317 - (3) 17W 24" T8  
332 - (3) 32W 48" T8  
340 - (3) 34/40W 48" T12  
417 - (4) 17W 24" T8  
420 - (4) 20W 24" T12  
432 - (4) 32W 48" T8  
440 - (4) 34/40W 48" T12

**BALLAST**  
B11 - Electronic T8  
E1 - Energy Saving  
Magnetic T12  
ESB - Residential  
Magnetic T12  
RES - Magnetic T12 LPF  
TS - Trigger Start (20W only)

**VOLTAGE**  
120V  
277V  
UNV - 120-277V

For additional information, see chart on pages 155-156.

# Cloud 2', 4'

## PHOTOMETRIC DATA, 2-40W 4' Model

CANDLEPOWER				LIGHT GUIDE (T12 LAMPS AND MAGNETIC BALLAST)				COEFFICIENT OF UTILIZATION													
Angle	0	45	90	Area/fixture in sq.ft./lg. room, good conditions - 8' to 10' ceilings				RC	80			70			50						
				Footcandles				RW	70	50	30	70	50	30	50	30					
					2-40W			RCR													
0	768	768	768					1	57	53	51	54	51	48	46	44					
5	765	767	766	35				2	51	46	42	48	44	40	40	37					
15	741	747	749	50				3	46	40	35	44	38	34	35	31					
25	688	703	711	75				4	42	35	30	40	34	29	31	27					
35	614	639	657	100				5	39	31	26	37	30	25	27	23					
45	521	559	591		AVERAGE LUMINANCE CD/SQ.M			LIGHT DISTRIBUTION				6	36	28	23	34	27	22	24	20	
55	408	469	516		Angle	0	45	90	Zone	Lumens	%Lamp	%Fixture	7	33	25	20	31	24	20	22	18
65	286	377	443		0	2104	2104	2104	0-30	607	9.6	17.3	8	31	23	18	29	22	17	20	16
75	58	292	369		45	1858	1610	1633	0-40	1007	16.0	28.6	9	28	21	16	27	20	16	19	15
85	57	219	304		55	1734	1500	1566	0-60	1855	29.4	52.7	10	27	19	15	25	18	14	17	13
90	27	191	274		65	1564	1404	1542	0-90	2740	43.5	77.9									
					75	1264	1350	1562	0-180	3517	55.8	100.0									
					85	900	1391	1708													

Lamps = (2) F40CW @ 3150 lumens ea. Input watts = 86 LER = 27 Test #05187 Ballast = Magnetic Ballast Factor = .66 S/MH: 0° = 1.3, 90° = 1.3  
Comparative yearly lighting energy cost per 1000 lumens = \$8.89 based on 3000 hrs. and \$.08 per KWH

## DRAWINGS AND DIMENSIONS

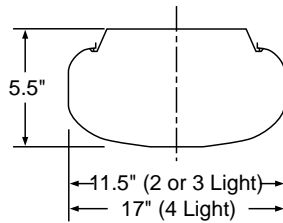

Lengths are 28" and 52"